

LED Shoebox

6" extruded mounting (EA6)

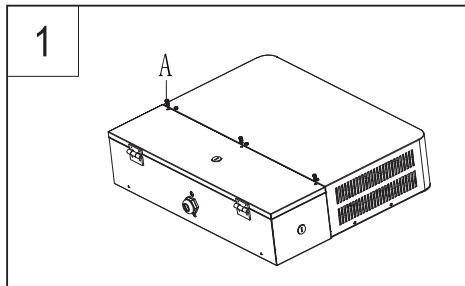

1. Unscrew the power chamber of the fixture.

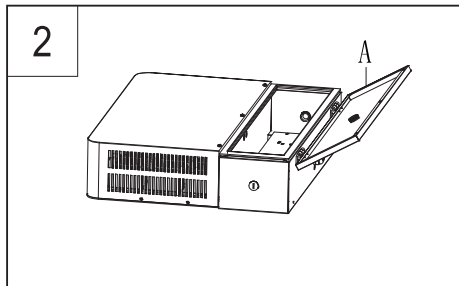

1. Open the power chamber.

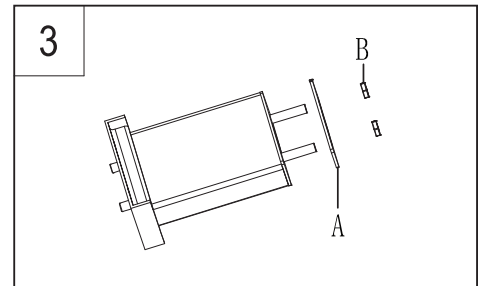

1. Separate the EA6 mounting and take out the plate A.

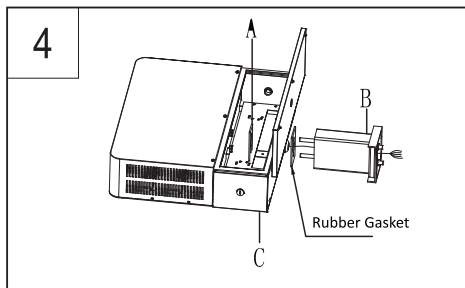

1. Guide the cable through the plate A, fixture hole, rubber gasket and mounting B.
2. Insert the mounting B into fixture body and plate A.
3. Keep them connected and screw tight.
Warning: the rubber gasket must be between the mounting B and fixture body.

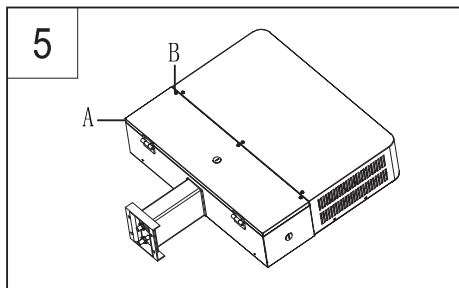

1. Close the power chamber and screw tight.

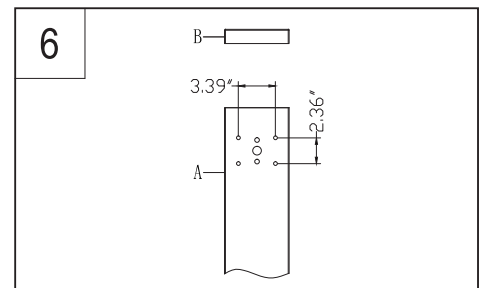

1. The hole position in pole is 3.39" by 2.36".
2. Take out the cap of pole.

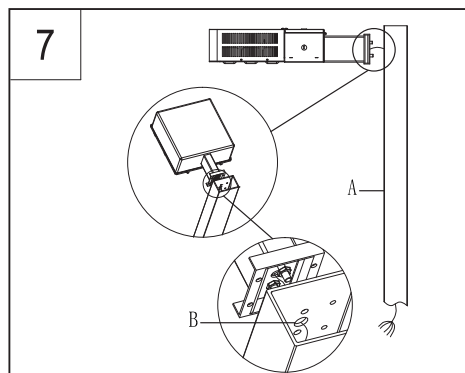

1. Guide the cable through the center hole B of pole and insert into the pole A.

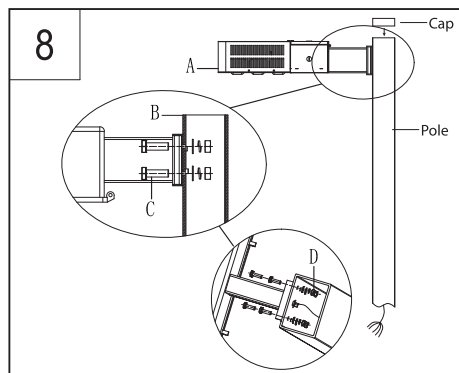

1. Connect the fixture A and pole B with screw C and nut B.
2. Put the cap back to the pole
Warning: Must be secure.

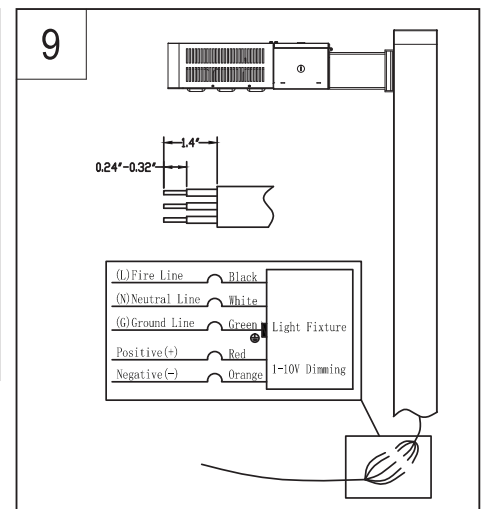

1. Refer to the diagram to remove the cable coating.
2. Connect the cable and input line.
Warning: hot line (L) for black wire, neutral line (+) for white wire and ground line for green wire, positive line for red wire and negative line for orange wire.
Warning: Power must be disconnected during installation.