

DAMAR®

UNDERCABINET LIGHT

To Begin

WARNING: Please read this entire manual before installation. Verify the following contents:

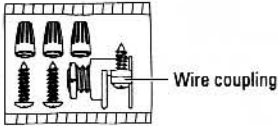
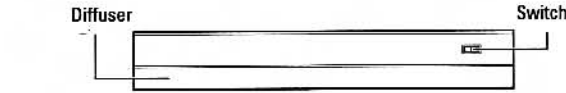

Hardware kit (Actual hardware may differ from illustration).

Warnings and Cautions

WARNING

- Shut off power at the circuit breaker or fuse panel before removing the old fixture or installing the new one.
- LEDs can be damaged by electro static discharge (ESD) shock. Before installation, discharge yourself by touching a grounded bare metal surface to remove this hazard. To avoid damage, do not remove the clear lens over the LED module.

CAUTION

- This device complies with Part 15 of the FCC rules. Operation is subject to the following two conditions: (1) This device may not cause harmful interference, and (2) this device must accept any interference received, including interference that may cause undesired operation.

Important Safety Instructions

WARNING: To reduce the risk of FIRE, ELECTRIC SHOCK, OR INJURY TO PERSONS:

- For **INDOOR USE ONLY**.
- Do **NOT** touch LEDs.
- Do **NOT** remove the protective clear LED lens.
- Do **NOT** look directly at lighted LEDs for any length of time.
- Do **NOT** touch, operate, or install fixture while in contact with water.
- Not intended for illumination of aquariums.
- Not intended for recessed installation in ceilings or soffits.
- Do **NOT** mount over sinks or stoves.
- Do **NOT** mount the light to cabinets having a material thickness less than 1/4 in.
- Do **NOT** install the fixture inside of enclosed cabinets.
- For electrical requirements, see back of the fixture. Minimum 90° supply conductors.
- Do not leave bare wires exposed outside of the electrical compartment.

SAVE THESE INSTRUCTIONS IN A LOCATION CLOSE TO THE FIXTURE TO REFER TO THEM AT A LATER TIME.

Dimmer Instructions

THIS FIXTURE IS DIMMABLE BY SPECIFIC FORWARD PHASE ELECTRONIC (TRAC) DIMMERS AND IS NOT COMPATIBLE WITH 0-10V DIMMING SYSTEMS. Dimmers tested to be compatible with this fixture are the Lutron: Diva® C-L™: DVWCL-153PH, Lumea® C-L™: LGCL-153PLH, and Toggler® C-L™: TGCL-153PH. (This list of dimmers does not imply any guarantee or warranty of compatibility with a particular application. Dimmers not listed do not imply non-compatibility.)

Direct Wire Installation

Disconnect power to the electrical box and remove the old fixture. If more than two wire leads are present, keep track of which wires were connected together.

- Fig. 1** Remove the diffuser by pulling back and up on the top edge (Fig. 1).

- Fig. 2** To open the wire compartment cover, disengage both chassis locking tabs by pushing in the side of wire compartment cover (Fig. 2) and lifting it up to expose the wire connections and hardware kit inside (Fig. 3).

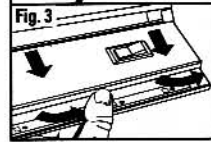

- Fig. 4** Mark the general area to install the fixture. Locate the mounting keyhole slots on the back of the fixture. Mark the corresponding placement on the mounting surface (Fig. 4).

- Fig. 5** Use an awl or nail to dimple the screw holes or drill a 1/16 in. pilot hole into the marked locations. Tighten the screws leaving 1/2 in. of the screw protruding from the surface (Fig. 5).

- Fig. 6** Determine which corresponding knock-out is closest to the supply wire feed and remove it. **CAREFULLY REMOVE THE KNOCK-OUT BY HAMMERING IT WITH A FLATHEAD SCREWDRIVER OR PUNCH UNTIL THE SURFACE BREAKS** (Fig. 6). If the knock-out does not break free, use pliers and bend it back and forth until it snaps off.

- Fig. 7** Attach the strain relief by inserting the threaded end through the knock-out (Fig. 7). Secure the strain relief to the fixture by tightening the fastener to the threaded tube. **NOTE:** Remember to have the strain relief oriented in a manner that allows tightening/loosening of the clamp after the fixture has been attached to the mounting surface.

- Fig. 8** Insert a flexible whip or NM cable (not included) through the strain relief and tighten the clamp until it is secure (Fig. 8). Allow enough wire length to make the connection. **WARNING:** Make sure the POWER is OFF.

- Fig. 9** For safety and proper operation, the fixture must be properly grounded. If unfamiliar with the methods of properly grounding the fixture, consult a qualified electrician. A copper ground wire is pre-attached to the fixture. If the electrical box is made of plastic and/or has a green or bare copper grounding wire inside, the fixture grounding wire and the electrical box ground wire should be connected using one of the wire nuts. If the fixture is being connected using a flexible whip or NM cable, the fixture grounding wire and the electrical supply ground wire should be connected using one of the wire nuts. Connect the supply leads to the fixture wire leads using the supplied wire nuts. The black leads from the fixture go to the black supply lead and the white leads from the fixture go to the white supply lead (Fig. 9). Tighten the wire nuts properly to prevent the wires from coming loose. If unsure of tightness, tape the wire nuts to the wire using electrical tape. (Fig. 10). Carefully push any excess wiring back inside the fixture.

- Fig. 11** Re-attach the wire compartment cover by hinging the cover with the fixture chassis and closing (Fig. 11). Press on the cover and secure the front lip under the locking tab (Fig. 12).

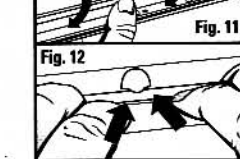

- Fig. 13** Slide the fixture over until the narrow ends of the keyhole slots are under the heads of the wood screws (Fig. 13). Finish tightening the wood screws until they are firmly seated and the fixture is tightly secured to the mounting surface.

- Fig. 14** Re-install the diffuser (Fig. 14).



www.damar.com

DAMAR®
805 N Carnation
Aurora, MO 65605
Made in China



ETL US
LISTED
Intertek
4008820